

Constant Current LED Driver

Circular/S

LED Driver 500/700mA **30W**



Product Features:

- 2 Model of Constant Current : 500mA and 700mA
- IP20
- Rated Input Voltage : 220-240Vac
- Power Factor ≥ 0.9
- Warranty : 30,000 hours
- Class II Protection
- Protection : Short and Open circuit proof, Overload protection

Conformities

EN 61347-1	EN 61347-2-13	EN 61547
EN 55015	EN 61000-3-2	EN 61000-3-3



Item No.	AED30-500ILSC	AED30-700ILSC	
Work Mode	Constant Current Version		
Output	Output Current	500mA	700mA
	Output Voltage Range	21-60V	15-43V
	Max. Output Voltage	Max. 64V	Max. 46V
	Output Power	10-30W	8.4-30W
	Ripple Current	-	
	THD(Full load)	$\leq 20\%$	
Input	Input Current	240mA	
	AC Input Voltage	220-240Vac	
	AC Input Voltage Range	198-264Vac	
	Input Frequency	50-60HZ	
	Max. Input Power	38.0W	38.1W
	Power Factor(Full load)	≥ 0.9	
	Efficiency	$\geq 83\%$	$\geq 83\%$
Others	Standby Power	$\leq 0.5W$	
	Dimension	$\Phi 85 \times 30 \text{mm}$	
	Lifetime	30000H	
	Approval	TUV/ENEC	TUV/ENEC

Physical Parameter

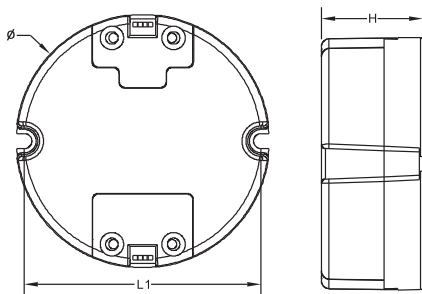

Φ : 85mm
 L1: 80.5mm H: 30mm
 Terminal block: Screw type
 Housing material: Polycarbonate
 Soldering: lead-free, comply with RoHS
 Label: Surface print
 Cable cross section: 0.5-1.0mm²
 Stripping: 6mm

Wiring Diagram

