

Constant Current LED Driver

Circular/S

LED Driver 350/500/700mA **20W**



Product Features:

- Wide range of Constant Current from 350-700mA
- IP20
- Rated Input Voltage : 220-240Vac
- Power Factor ≥ 0.5
- Warranty : 30,000 hours
- Class II Protection
- Protection : Short and Open circuit proof, Overload protection

Conformities

EN 61347-1 EN 61347-2-13 EN 61547
EN 55015 EN 61000-3-2 EN 61000-3-3



Item No.	AED20-350ILSC	AED20-500ILSC	AED20-700ILSC	
Work Mode	Constant Current Version			
Output	Output Current	350mA	500mA	700mA
	Output Voltage Range	18-55V	11-38V	8-27V
	Max. Output Voltage	Max. 63V	Max. 43V	Max. 32V
	Output Power	4.2-13.3W	4.5-13W	4.2-12.6W
	Ripple Current	10%		
	THD(Full load)	-		
Input	Input Current	240mA		
	AC Input Voltage	220-240Vac		
	AC Input Voltage Range	198-264Vac		
	Input Frequency	50-60HZ		
	Max. Input Power	24.5W	23.8W	24.5W
	Power Factor(Full load)	≥ 0.5		
	Efficiency	$\geq 85\%$	$\geq 85\%$	$\geq 84\%$
	Standby Power	$\leq 0.5W$		
Others	Dimension	$\Phi 65 \times 26 \text{mm}$		
	Lifetime	30000H		
	Approval	TUV/ENEC	TUV/ENEC	TUV/ENEC

Physical Parameter

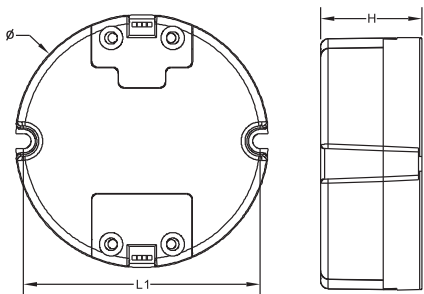

Φ : 65mm
 L1: 61mm H: 26mm
 Terminal block: Screw type
 Housing material: Polycarbonate
 Soldering: lead-free, comply with RoHS
 Label: Surface print
 Cable cross section: 0.5-1.0mm²
 Stripping: 6mm

Wiring Diagram

