

Constant Current LED Driver

Circular/S

LED Driver 350/500/700mA **12W**



Product Features:

- Wide range of Constant Current from 350-700mA
- IP20
- Rated Input Voltage : 220-240Vac
- Power Factor ≥ 0.5
- Warranty : 30,000 hours
- Class II Protection
- Protection : Short and Open circuit proof, Overload protection
- Round shape : $\Phi 57\text{mm}$

Conformities

EN 61347-1 EN 61347-2-13 EN 61547
EN 55015 EN 61000-3-2 EN 61000-3-3



Item No.	AED12-350ILSC	AED12-500ILSC	AED12-700ILSC	
Work Mode	Constant Current Version			
Output	Output Current	350mA	500mA	700mA
	Output Voltage Range	12-38V	9-26V	6-18V
	Max. Output Voltage	Max. 40V	Max. 29V	Max. 21V
	Output Power	4.2-13.3W	4.5-13W	4.2-12.6W
	Ripple Current	10%		
	THD(Full load)	-		
Input	Input Current	155mA		
	AC Input Voltage	220-240Vac		
	AC Input Voltage Range	198-264Vac		
	Input Frequency	50-60HZ		
	Max. Input Power	16W	16.2W	15W
	Power Factor(Full load)	≥ 0.5		
	Efficiency	$\geq 80\%$	$\geq 81\%$	$\geq 82\%$
	Standby Power	$\leq 0.5\text{W}$		
Others	Dimension	$\Phi 57 \times 22\text{mm}$		
	Lifetime	30000H		
	Approval	TUV/ENEC	TUV/ENEC	TUV/ENEC

Physical Parameter

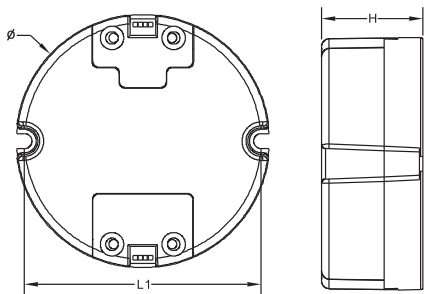

Φ : 57mm
L1: 52mm H: 22mm
Terminal block: Screw type
Housing material: Polycarbonate
Soldering: lead-free, comply with RoHS
Label: Surface print
Cable cross section: 0.5-1.0mm²
Stripping: 6mm

Wiring Diagram

